

Fanlight Catches

First seen in the George Allart catalogue of 1938 the 'Allart Patent Oil Bath Fanlight Catch' offered many unique features which enabled it to become a classic of its time.

Originally designed for Pole Hook operation of bottom hung open-in traditional fanlights, today a version with a reversed shoot for open-out applications is also available.

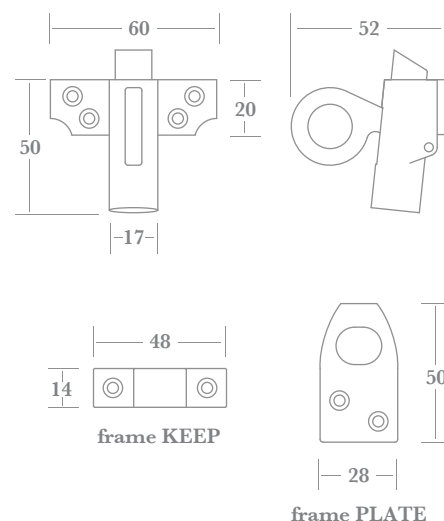

▲ **0737** (supplied with both KEEP & PLATE).
0737K (supplied with KEEP only). **0737P** (supplied with PLATE only).

REVERSED SHOOT
designed for
OPEN - OUT
windows

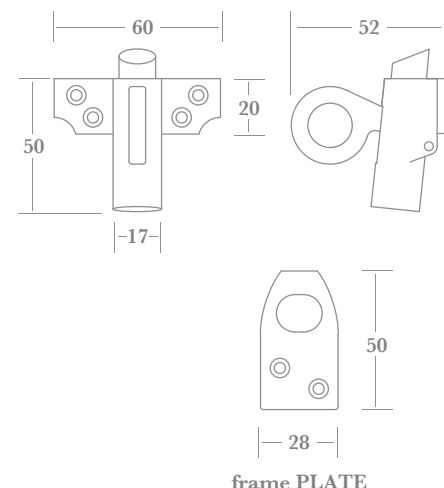

▲ **0738** (supplied with PLATE only).

Fixings

Supplied with finish matched
no.6 x 19mm wood screws.

INTEGRATED FANLIGHT CATCH & STAY BAR

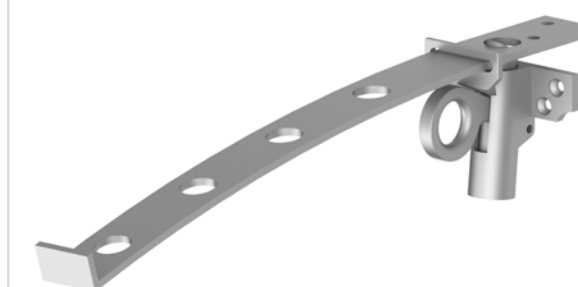

Integrated Fanlight
Catch & Stay Bar
designed for circular and
shaped open-in windows
where standard Fanlight
Stays cannot be used.
Available made-to-order
only.

Fanlight Stays & Pole Hook

The 4589 Fanlight Stay is designed to limit the opening position of a traditional bottom hung open-in fanlight window. It is sold singly, but can be used in pairs.



▲ 4589

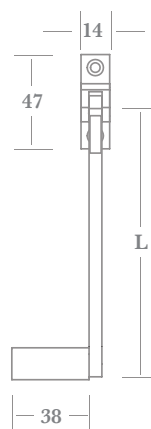

	A	B
L (length)	152	203

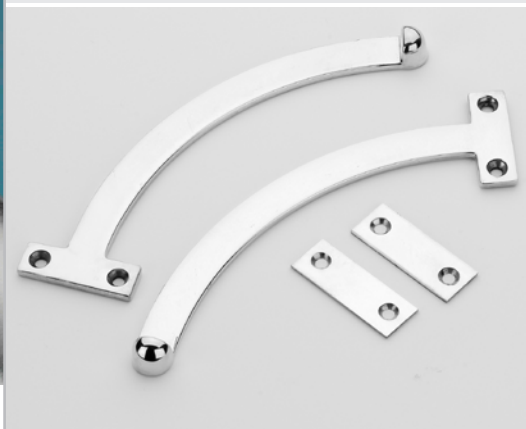

▲ 0740

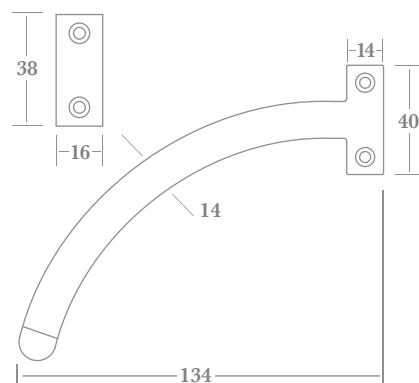

The 0740 Fanlight Stay Set is designed to be fitted as a pair to a traditional bottom hung open-in fanlight window. It is supplied with Strike Plates to protect the window face from damage.

The Pole Hook is designed to accept a formed 25mm wooden pole. A Pole Hook Holder for wall fixing is also available.

Fixings

Supplied with finish matched
no.6 x 19mm wood screws, except 4589
supplied with finished matched
no.8 x 25mm wood screws.



▲ 2155 Pole Hook



▲ 2159 Pole Hook Holder

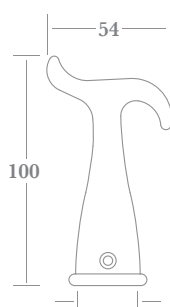

Suitable for Ø25mm
Wooden Pole

